

GB	Assembly instruction
S	Monteringsanvisning
N	Monteringsveiledning
DK	Monteringsvejledning
FI	Asennusohje
RU	Инструкция по монтажу
EE	Paigaldusjuhised
LT	Montavimo instrukcijos

	A
800 x 2000	768 – 773
900 x 2000	868 – 874
1000 x 2000	968 – 975
1100 x 2000	1068 – 1073
1200 x 2000	1168 - 1173
1400 x 2000	1368 – 1373
1600 x 2000	1568 - 1573

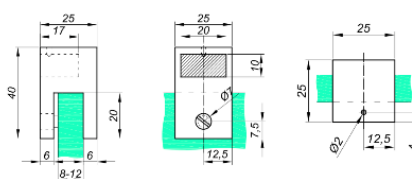

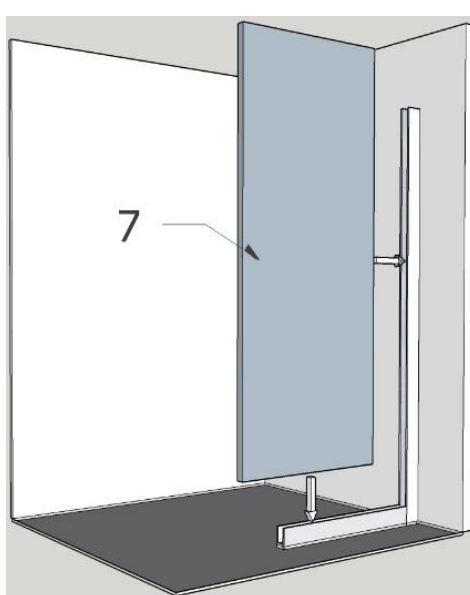
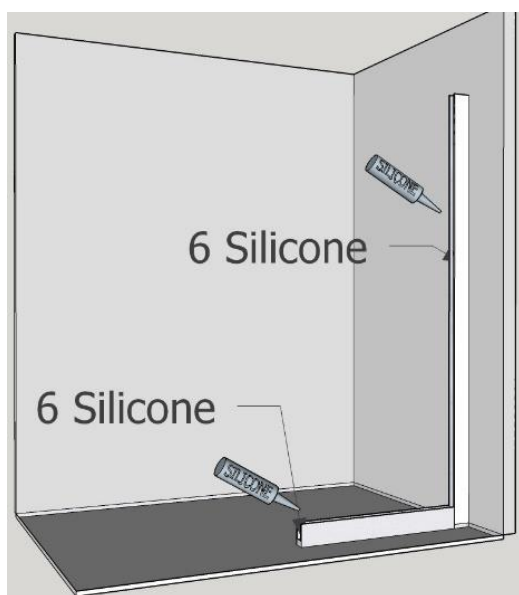
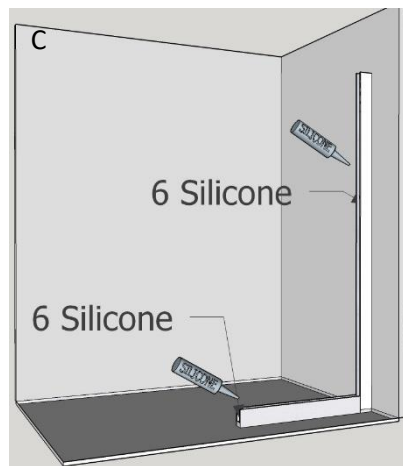
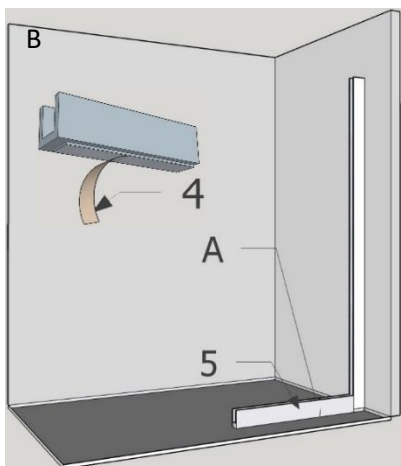
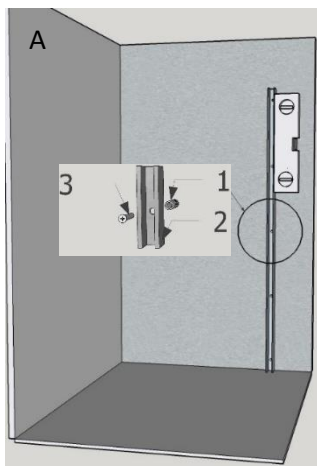
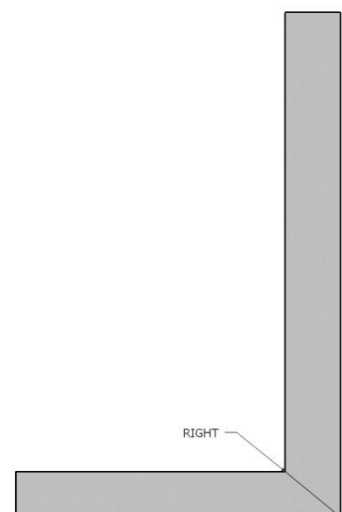
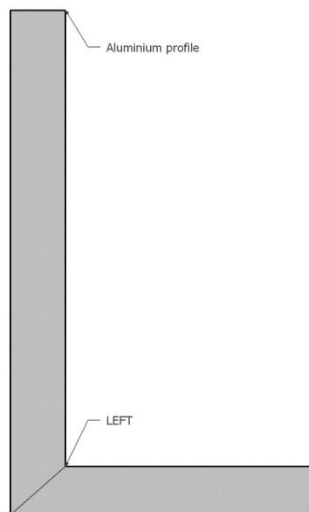
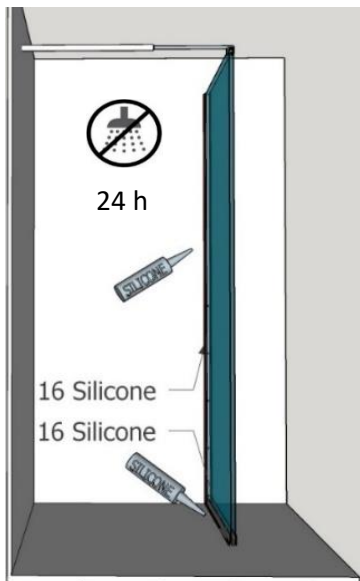
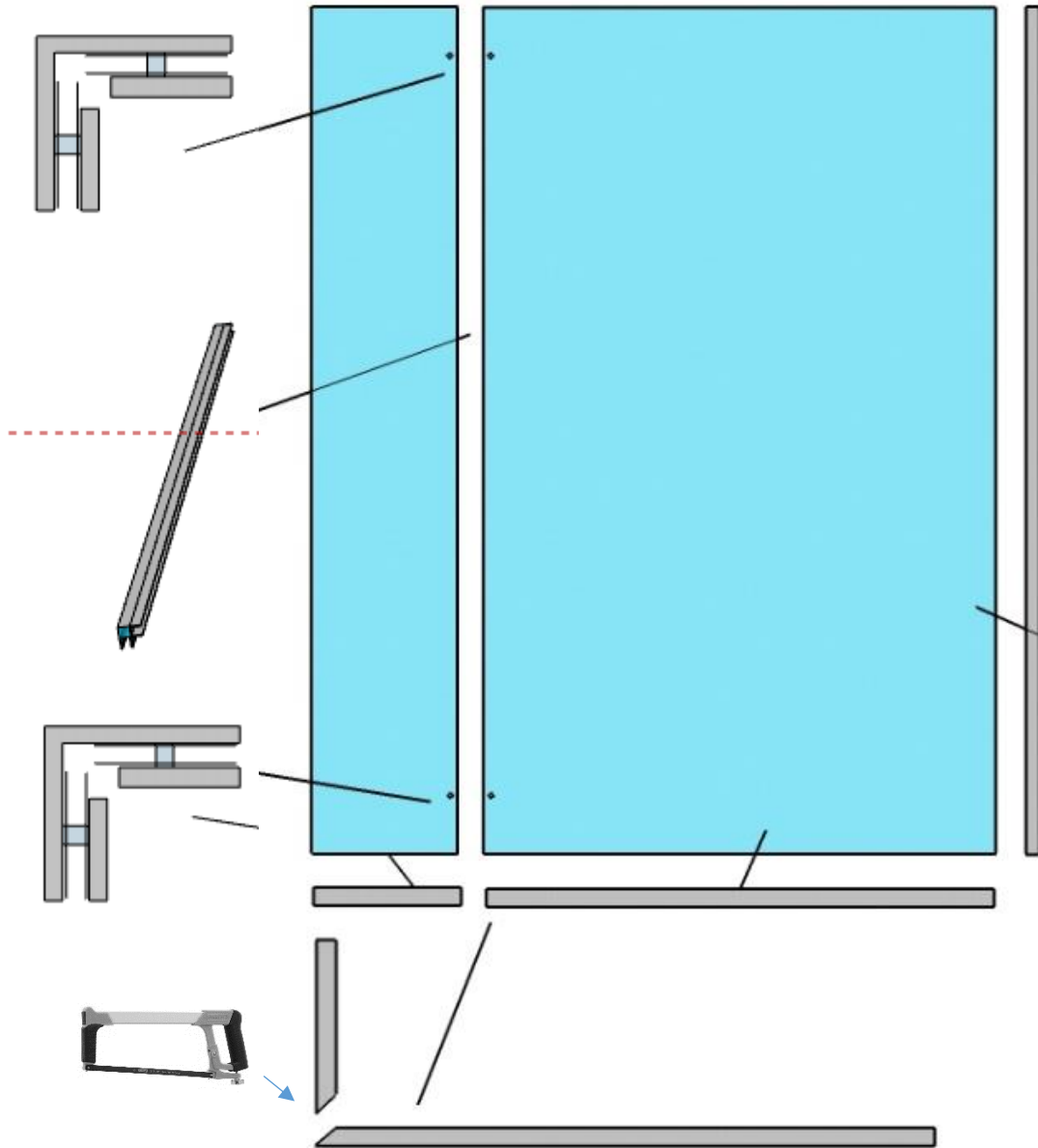

Grollo
SHOWER ENCLOSURES